



GTX-15 Technical Specifications

High Definition · 53' Double Expando · Multi-Format (Native 1080i, 720p, 24p, 30p)

PRODUCTION & EFFECTS

Grass Valley K Frame Kayenne Elite HD Switcher
128 Inputs / 64 Outputs / 9 Mix Effects
6 Downstream Keyers per M/E
Programmable Clean Feed
16 iDPM / 4 eDPM
Chroma Key on all M/E's
K2 Summit 4-Channel Server
32 GB Image Storer
Clip Store w/ 10 Fill & Key Channels
FlexiKey and Double Take
EVS 4 Channel HD XT2+Spot Box w/Interface
and Lance Controller
NVision 288x576 HD/SD Router

VIRTUAL MONITOR WALL

18 32" 16 x 9 LCD HD Monitors
Evertz VIP x Routing & Multi-Image Display

GRAPHICS

Chyron HyperX3

AUDIO

Calrec Alpha Digital Console w/ Bluefin
76 Dual Faders (162 Stereo, 156 Mono,
78 Surround, 48 Multi-Track)
MADI Interface w/ 128 Inputs x 128 Outputs
128x128 Analog/96x96 AES)
Dual Processor Engines
Genelec 5.1 Surround Sound Monitoring DK
Stereo Surround Audio Display
Dolby E System (DP570, DP571, DP572,
DP563, DP564, DM100)
Yamaha SPX2000 Multi-Effects Processor
3 dbx 166 XL Compressors
2 dbx 1046 Quad Compressors
2360 Systems Digicart/E Ethernet Audio
Recorders 1 w/ Zip Drive
1 Denon CD Player
1 Concerto 448x448 Stereo Router
(256x256 AES/192x192 Analog)
24 Benchmark Stereo Analog DAs
8 Benchmark 4 Channel AES DAs
2 Neural Upmix
2 Neural Downmix
2 Neural Mono to Stereo
1 Neural Loudness Meter
Add'l. Specialty Audio (Upon Request)

REPLAY/RECORD

4 EVS HD XT2+ LSM 6 Channel
1 EVS HD XT2+ XFile Archive Station
EVS Sports Net2 Hub
EVS IP Director Package – upon request
2 Panasonic HD 1800 DVC Pro
1 Sony HDW-2000 HDCAM
1 Sony DVW-A500 Digital Betacam Recorder
4 DVD SD Recorder/Players
2 DNF Slow Motion Controllers

TERMINAL

Evertz Master Timecode Generator
Evertz Control System
Evertz Digital Time Displays
Evertz Changeover
10 AJA SD-HDI Upconverters
50 AJA HD-SDI Downconverters
5 AJA FS2 Frame Sync/Format Converters
10 AJA FS1 Converters
1 Quad Split Generator
2 HD Color Correctors
DSS Receiver
Digital Demodulator
2 Evertz 16ch Embedders

F&F Productions, LLC

14333 Myerlake Circle · Clearwater, FL 33760 · (727) 530-5000 · info@fandfhd.tv

CAMERAS & SUPPORT (Wired for 24 Cameras)

12 Ikegami HDK-79EC Native Multi-Format
CMOS Cameras w/ Triax Adapters
4 Point Star Filters, Fixed or Variable Speed
Shutter 1/60 to 1/2000 shutters
SMPTE Fiber Operation (Upon Request)
7 Ikegami Super Expanders w/
VFL 900 LCD Color Viewfinders
7 Vinten Vector 700 Pan Heads & Tripods
4 Vinten Vision 11 Pan Heads & HH Tripods
3 Vinten Dolly Wheels for Hard cameras
2 Studio Build-Up Kits for Handheld cameras
2 Sony 70I SClock Cameras, Triax Operation
2 Ikegami HDL50 POV Cameras
1 Panasonic Varicam ENG Camera w/ 22x7.8 lens
(Fiber Operation Only and Upon Request)
Add'l. Cameras, Expanders, & SSMO
(Upon Request)

HDTV LENSES

5 Fujinon 101 x 8.9 Studio/Field w/stabilization
2 Fujinon 88 x 8.8 Studio/Field w/stabilization
4 Fujinon 22 x 7.8 ENG/EPF Handheld lenses
2 Fujinon 13 x 4.5 ENG/EPF HH Wide Angle
Add'l. Specialty Lenses (Upon Request)

EXTERNAL MONITORS

3 20" LCD HD Booth Monitors
4 15" LCD Field Monitors
8 9" LCD Monitors
Additional Monitors Upon Request

MICROPHONES

6 Sennheiser HMD-25 Announcer Headsets
6 Sennheiser ME67MP Shotgun Mics
6 Sennheiser MKH416 Shotgun Mics
5 Sennheiser MD 46 Mics
5 Sennheiser MKH 70 Mics
6 EV 635A Mics
6 Sony ECM77B Lavalier Mics
6 Daltech Talk Back Boxes
Add'l. Specialty Mics (Upon Request)

COMMUNICATIONS

RTS Adam 128x128 Matrix w/
1 RVON VOIP Interface
16 IFB Channels
15 KP-32 ICOM Stations
5 KP-12 ICOM Stations
15 RTS IFB Belt Packs
30 BP-325 Dual Listen Belt Packs
11 Single Muff Headsets
12 Double Muff Headsets
20 Lightweight Headsets
4 TIF and 3 QKTs
1 PBX Phone System w/12 lines
4 Ringdown circuits, Instruments
6 Two Way Radios w/ Base Station
Add'l. KP Panels, BP, Telos (Upon Request)

MISCELLANEOUS EQUIPMENT

2 Lowell Light Kits w/ 4 Instruments each

BOOTH FIBER PACKAGE

Telecast Adder II
64 Audio Channels (4X16 Configurable)
4 Data Channels (Bi-directional) Telecast
Viper w/6 HD/SDI, 1 Analog NTSC 1500'
Single Mode TAC 12

CABLE

3000' DT 12 Audio Mult
3000' Single Audio (various lengths)
6000' Mini Triax (additional upon request)
2000' Coax Video (various lengths)
5 Pair and 10 Pair Coax Mults (various lengths)
Add'l. Cable & SMPTE Fiber (upon request)

POWER REQUIREMENTS

3 Phase, 208 Volt, 400 amps
(200 amp environmental, 200 amp technical)
Maximum distance from Power Panel: 150'

DIMENSIONS (Expanded)

W/Tractor: 74' L x 13'6" H x 16' W
Without Tractor: 56' L
Working Footprint: +5' around

B UNIT (Optional and Upon Request)

DIMENSIONS

W/ Tractor: 73' L x 13'6" H x 8'6" W
Without Tractor: 55' L
Working Footprint: +5' around

F&F Productions, LLC

14333 Myerlake Circle · Clearwater, FL 33760 · (727) 530-5000 · info@fandfhd.tv



GTX-15 Virtual Monitor Wall

High Definition · 53' Double Expando · Multi-Format (Native 1080i, 720p, 24p, 30p)

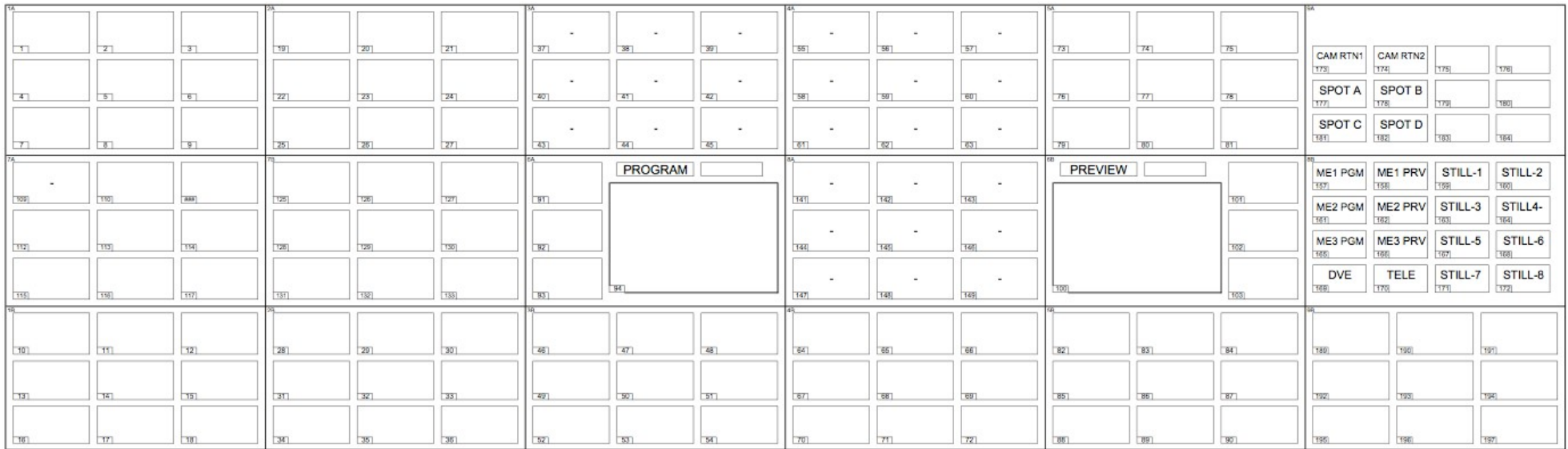

F&F Productions, LLC

14333Myerlake Circle · Clearwater, FL 33760 · (727) 530-5000 · info@fandfhd.tv



GTX-15 Truck Layout

High Definition · 53' Double Expando · Multi-Format (Native 1080i, 720p, 24p, 30p)

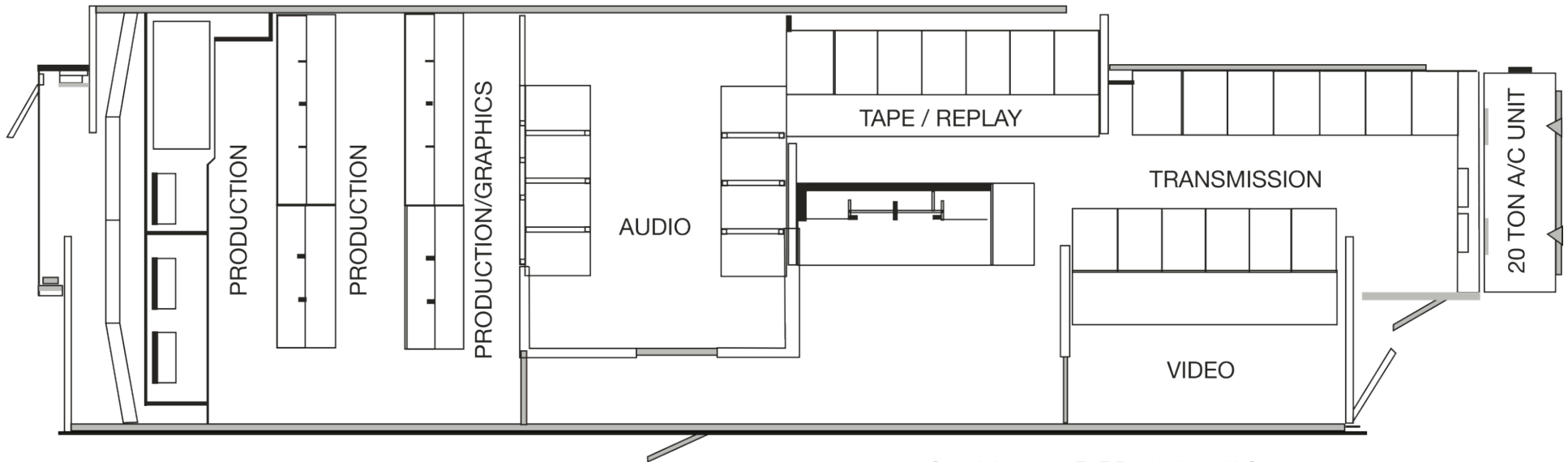

Copyright ©2012 F&F Productions, LLC

F&F Productions, LLC

14333 Myerlake Circle · Clearwater, FL 33760 · (727) 530-5000 · info@fandfhd.tv